

Typical Section with Steel Fibre Shotcrete (Type S2)

Rockmass Quality	Support type and amount				Remarks
	Type	Rockbolting Dia=20-25mm	Shotcrete thickness	Concrete lining(mm)	
Q2 Poor to Fair Quality Q-Value 1 to 5	S2	L=3.5m, 20mm dia Systematic bolting @ 1.7 c/c crown and @ 1.7 c/c wall	Fibre Reinforced shotcrete 50 mm at crown and walls	NA	Blocky and seamy, imperfectly interlocked, moderately strong rock within clay layers and locally fractured.

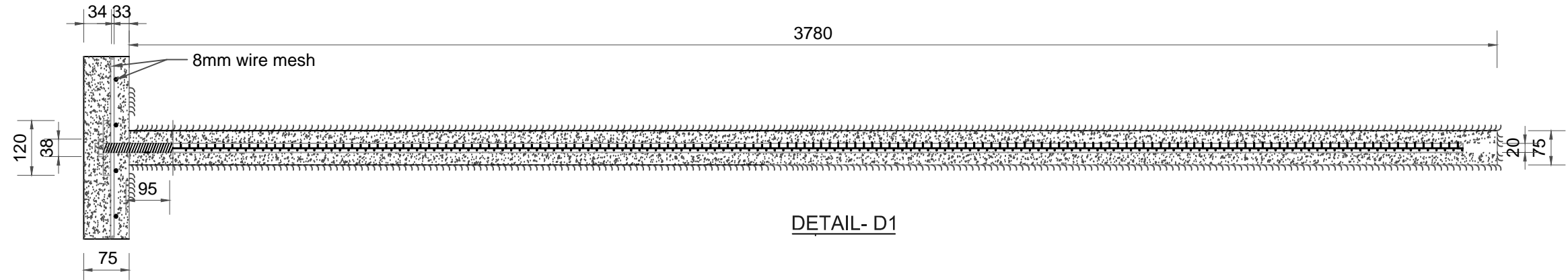

DETAIL- D1